

FLOOR PLAN GENERAL NOTES

- A. ALL DIMENSIONS ARE TO FINISH U.O.N.
- B. WRB WRAP SHALL BE TYVEK 'COMMERCIAL WRAP' OR APPROVED EQUAL
- C. ALL INTERIOR WALLS SHALL BE 3 5/8" LT. GA. METAL STUD FRAMING (U.O.N.). EXTERIOR WALL STUDS SHALL BE 1 1/2" GA. 3 5/8" STEEL W/ SPACING AS NOTED.
- D. CONTRACTOR SHALL RE-USE EXISTING PLUMBING FIXTURES LOCATED IN THE YOUTH ROOM M111A WHERE POSSIBLE AND NO DAMAGE EXISTS AN THEY MEET CURRENT CODES AND STANDARDS.
- E. ALL GYP. BOARD ON INTERIOR AND EXTERIOR WALLS OF THE MESHAW BUILDING SHALL BE 5/8" IMPACT RESISTANT TYPE 'X' GYP. BOARD (NATIONAL GYPSUM 'HI-IMPACT XP' OR EQUAL)
- F. DOORS ON PLANS W/OUT IDENTIFICATION MARKS ARE NOT IN CONTRACT.

WALL TYPE LEGEND

- EXTERIOR WALLS:**
- ALTERNATE M-1:
4" FACE BRICK (MATCH EXISTING), 1" CAVITY, ADJUSTABLE MASONRY WALL TIES @ 16" O.C. HORIZ. + VERT. (STAGGERED), 2" RIGID CONTINUOUS R-15 INSULATION, (2) LAYERS OF MOISTURE BARRIER BUILDING WRAP ON 7/16" EXTERIOR OSB SHEATHING, 3 5/8" 1 1/2" GA. MTL. STUDS @ 12" O.C. (MAX.), 5/8" IMPACT RESISTANT GYP. BOARD.
- EXISTING BRICK VENEER EXTERIOR WALL TO REMAIN
- INTERIOR WALLS:**
- 5/8" TYPE 'X' GYP. BD. ON 3 5/8" MTL. STUDS (2X4 WD STUDS AT SANCTUARY BUILDING) @ 12" O.C., 5/8" TYPE 'X' GYP. BOARD.
- CMU WALL WITH VERT. #4 REBAR REIN. @ 32" O.C., DRILL INTO EXISTING CONC. SLAB AT BASE OF WALL AND EPOXY #4 DOWELS AT CELLS W/ VERT. REINFORCEMENT. THICKNESS AS SHOWN ON DRAWINGS. (PROVIDE OVERHEAD BRACE PER DETAIL 2/A301)
- EXISTING INTERIOR WALL TO REMAIN
- EXISTING INTERIOR STUD WALL TO RECEIVE NEW 5/8" GYP. BD. EA. SIDE OF FINISHED WALL.

FLOOR PLAN KEYNOTES

1. FLOORING TRANSITION BORDER, REFER TO FINISH SCHED. SHEET A603
2. 1 O# ABC FIRE EXTINGUISHER AND CABINET
3. EXISTING PEMB STL. COLUMN
4. FLOOR DRAIN, TYP. AND SHOWN THUS (REFER TO PLUMBING DWGS)
5. 1" SOLID PHENOLIC, OVERHEAD BRACED TOILET PARTITION AND/OR URINAL SCREEN (BOBRICK - SIERRASERIES 1092G OR EQUAL)
6. INSTALL NEW 5/8" IMPACT RESISTANT GYP. BOARD, FINISH OVER EXISTING WALL STUDS UP TO 10'-0" HIGH WHERE MISSING (FIELD VERIFY HT.)
7. WALL SHALL RECEIVE ACCENT WALL PAINT COLOR REFER TO ROOM FINISH LEGEND SHEET A603.
8. EXISTING BASKETBALL GOALS TO REMAIN, USE AS REFERENCE POINTS FOR COURT LINES.
9. EXISTING RECESSED VOLLEYBALL SLEEVE TO REMAIN, REPLACE DAMAGED CAP AS NECESSARY.
10. PAINTED GYM FLOOR LOGO TO MATCH SCHOOL ARTWORK
- ALT. M-2: IN AREAS ON WALLS INDICATED, REMOVE AND DISPOSE OF EXISTING WOOD WALL PANELING IN ITS ENTIRETY. PREP STUDS, AND INSTALL NEW 5/8" IMPACT RESISTANT GYP. BD. (NATIONAL GYPSUM 'HI-IMPACT XP' OR EQUAL.
12. INFILL LT. GA. METAL FRAMING AS REQUIRED FOR GYP. BD. INSTALLATION.
13. EXISTING EXTERIOR SIDEWALK TO REMAIN.
14. DEMO EXISTING BRICK WING WALL, TOOTH BRICK IN TO FORM A FINISHED CORNER AND PREP FOR NEW PAINT FINISH.
15. SOLID WOOD TRANSITION RAMP BY WOOD GYM FLOOR MANUF., REFER TO DETAIL 1/A302.
16. INSTALL NEW 5/8" TYPE 'X' GYP. BD. ON EXISTING STUD WALL FRAMING, FIELD VERIFY LOCATIONS ON WALL.

**MESHAW BUILDING
FIRST FLOOR PLAN - AREA A**

SCALE: 1/8" = 1'-0"

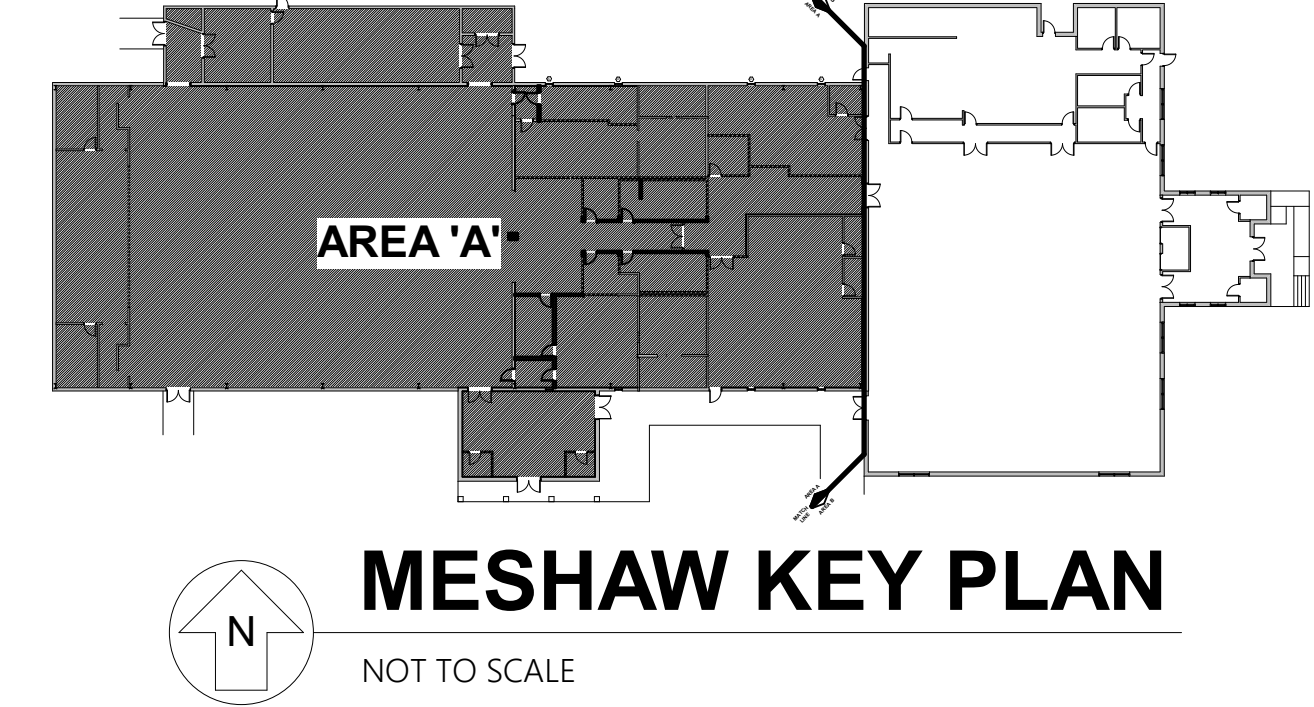

hostellerarchitecture

■ ARCHITECTURE ■ PLANNING

3967 MARKET STREET
WILMINGTON, NC 28403
PHONE: 910.612.1119
www.hostellerarchitecture.com

CONSULTANTS

RENOVATIONS TO

**GRACE
BAPTIST
CHURCH**

WILMINGTON
NORTH CAROLINA

HOSTELLER ARCHITECTURE
STATE REGISTRATION

53256

ARCHITECT OF RECORD
SHAWN E. HOSTELLER
11926

CONSTRUCTION DOCUMENTS : 02.08.19

REVISIONS		
MARK	DATE	DESCRIPTION
△		
△		
△		
△		
DRAWN BY:		PROJ. MGR:
SHEET CONTENT		

MESHAW BUILDING FIRST FLOOR PLAN -
AREA A (BASE BID)

JOB NO. 18013	SHEET A107
------------------	---------------